

Aspen
Alcove - A

490 sq. ft.

Dimensions are approximate.

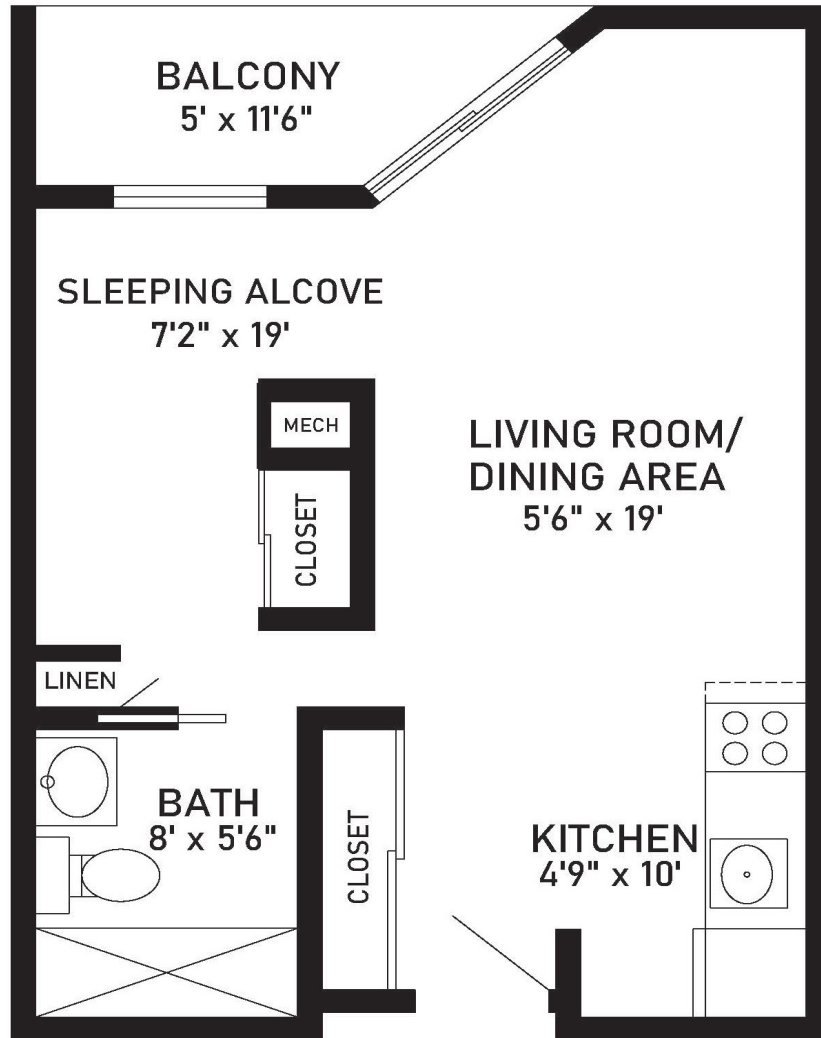

5800 St Croix Avenue North, Golden Valley, MN 55422 (763) 732-1521 CovLivingGoldenValley.org

Covenant Living Communities & Services is a ministry of the Evangelical Covenant Church and does not discriminate pursuant to the federal Fair Housing Act. All faiths and beliefs are welcome.

